

hama®

THE SMART SOLUTION

Halter „Magic Stand/Docking” Holder für/for Apple iPad/iPhone/iPod



**00106351
00106379**

ⓓ Bedienungsanleitung

Danke, dass Sie sich für ein Hama-Produkt entschieden haben. Bitte lesen Sie vor der Inbetriebnahme des Produktes die vorliegende Bedienungsanleitung.

Aufbau des Stands /der Dockingstation

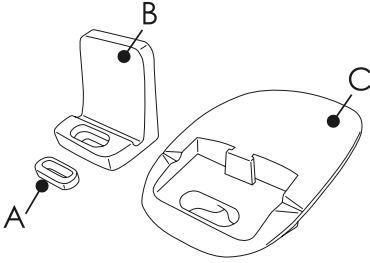

A : Silikon – Apple 30-Pin-Stecker-Fixierung
B : Geräte-Halter
C : Basis

Zusammenbauen des Stands / der Docking-Station

Schritt 1:

Installieren Sie die Komponente B auf der Basis C.

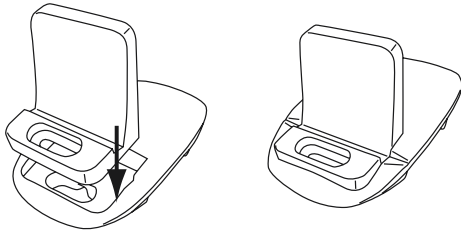

Schritt 2:

Möchten Sie den „Magic Stand“ als Docking-Station nutzen? Dann gehen Sie bitte folgendermaßen vor:

Führen Sie den Original Apple 30-Pin-Stecker (00106351: kein Lieferumfang) durch die Komponenten C + B.

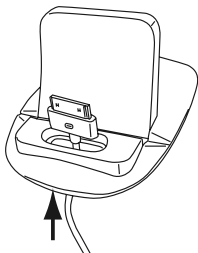

Schritt 3:

Fixieren Sie nun den 30-Pin-Stecker mit Hilfe der Silikon-Stecker-Fixierung (A).

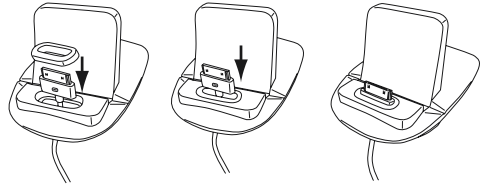

Schritt 4:

Befestigen Sie nun das Kabel auf der unteren Seite im dafür vorgesehenen Kabel-Organizer.

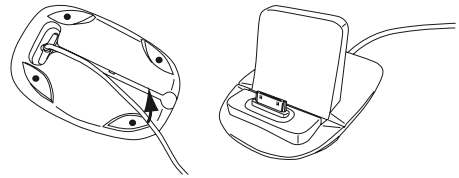

Ihr „Magic Stand“ ist nun bereit zur Nutzung mit Ihrem iPhone/iPod/iPad

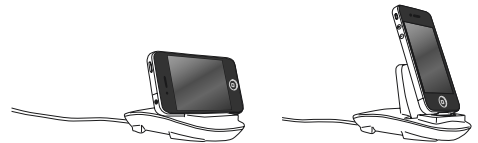

Ⓜ Operating Instruction

Thank you for choosing a Hama product. Please read these operating instructions carefully before you use the product.

Stand / docking station layout

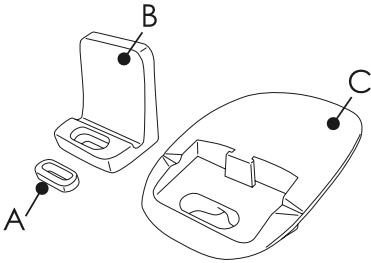

A: Apple 30-pin plug attachment (silicone)
B: Device holder
C: Base

Stand / docking station assembly

Step 1:

Install component B onto base C.

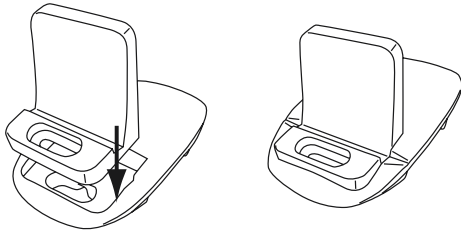

Step 2:

Would you like to use the "Magic Stand" as a docking station? Then proceed as follows:

Feed the original Apple 30-pin plug (00106351: not included in delivery) through components C and B.

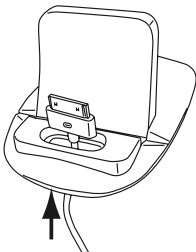

Step 3:

Secure the 30-pin plug using the silicone plug attachment (A).

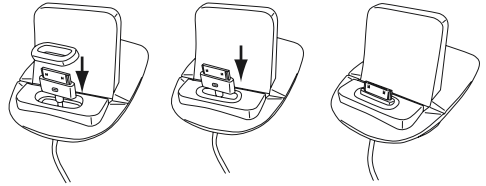

Step 4:

Secure the cable on the underside in the cable organiser provided.

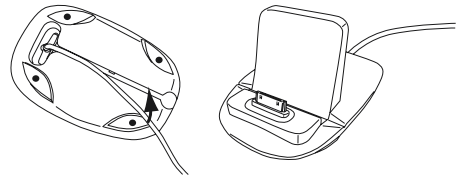

Your "Magic Stand" is now ready for use with your iPhone/iPod/iPad.

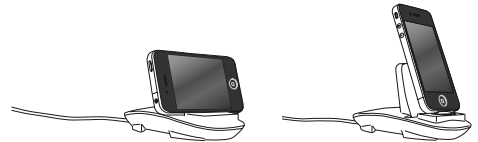

F Mode d'emploi

Nous vous remercions d'avoir choisi un produit Hama. Veuillez lire le présent mode d'emploi avant la mise en service du produit.

Montage du support / de la station d'accueil

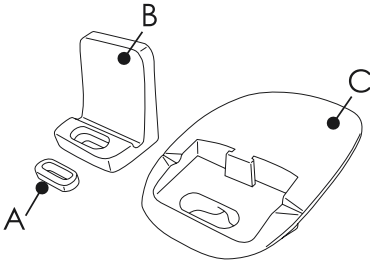

A : Fixation pour connecteur Apple 30 broches en silicone
B : Support de l'appareil
C : Station de base

Assemblage du support / de la station d'accueil

Etape 1 :

Installez le composant B sur la station de base C.

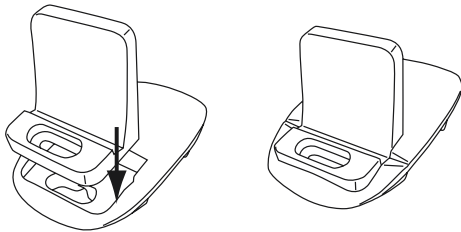

Etape 2 :

Souhaitez-vous utiliser le support « Magic Stand » comme station d'accueil ? Veuillez procéder comme suit :

Insérez le connecteur Apple 30 broches d'origine (00106351; non fourni) dans les composants C + B.

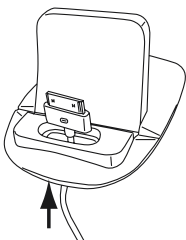

Etape 3 :

Fixez le connecteur 30 broches à l'aide de la fixation en silicone (A).

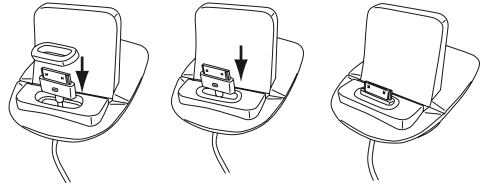

Etape 4 :

Fixez le câble sur la face inférieure dans l'organiseur de câbles prévu à cet effet.

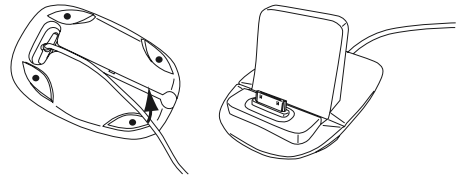

Vous pouvez désormais utiliser le support « Magic Stand » avec votre iPhone/iPod/iPad.

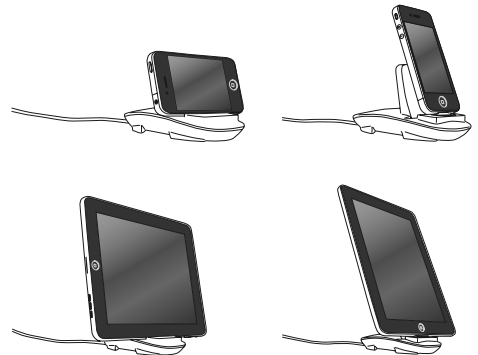

E Instrucciones de uso

Celebramos que se haya decidido por un producto de Hama. Lea atentamente las presentes instrucciones de uso antes de poner en servicio el producto.

Estructura del stand /de la estación docking

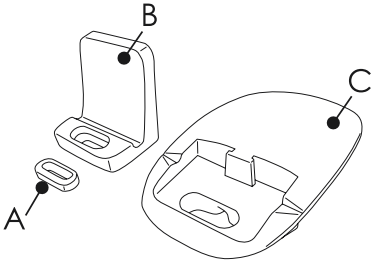

A : Fijación de silicona del conector Apple de 30 pines

B : Soporte de aparatos

C : Base

Ensamblaje del stand / de la estación docking

Paso 1:

Instale el componente B sobre la base C.

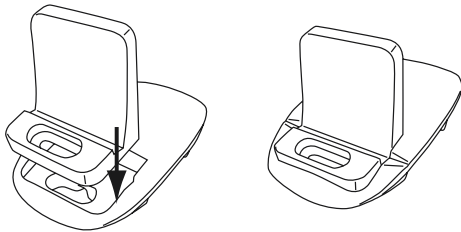

Paso 2:

Si desea utilizar el „Magic Stand“ como estación docking, proceda del siguiente modo:

Pase el conector original Apple de 30 pines (00106351: no incluido en el volumen de suministro) por los componentes C + B.

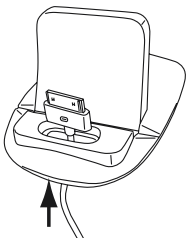

Paso 3:

Sujete ahora el conector de 30 pines con ayuda de la fijación de silicona del conector (A).

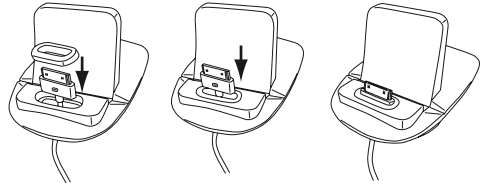

Paso 4:

Sujete ahora el cable en la parte inferior en el organizador de cables previsto para este fin.

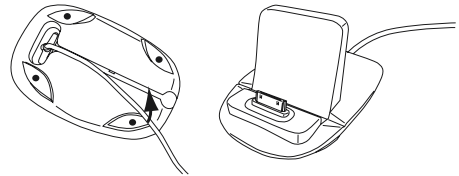

Su „Magic Stand“ está listo ahora para el uso con su iPhone/iPod/iPad.

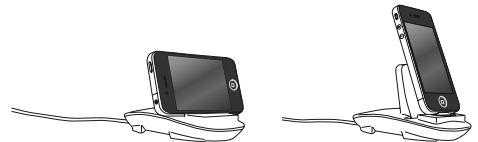

NL Gebruiksaanwijzing

Hartelijk dank dat u voor een product van Hama heeft gekozen. Lees voor de ingebruikname van het product deze gebruiksaanwijzing.

Opbouw van standaard/dockingstation

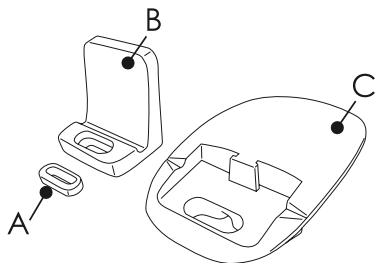

A: siliconen stekkerbevestiging 30-pins van Apple
B: apparaathouder
C: basis

Montage van standaard/dockingstation

Stap 1:

Installeer de componenten B op de basis C.

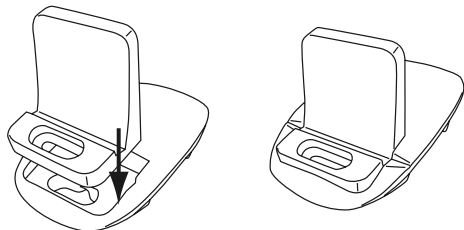

Stap 2:

Wilt u de „Magic Stand“ als dockingstation gebruiken?
Ga dan als volgt te werk:

Leid de originele 30-pins-stekker van Apple
(00106351: niet inbegrepen) door de componenten C + B.

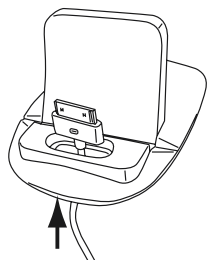

Stap 3:

Bevestig vervolgens de 30-pins-stekker met behulp van de siliconen stekkerbevestiging (A).

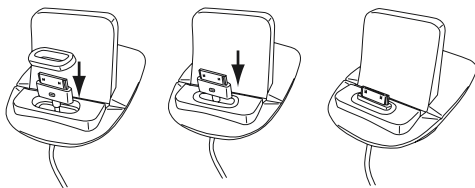

Stap 4:

Bevestig nu de kabel op de onderste zijde in de daarvoor bestemde kabelorganizer.

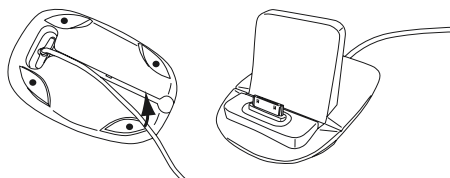

Uw „Magic Stand“ kan nu gebruikt worden in combinatie met uw iPhone/iPod/iPad.

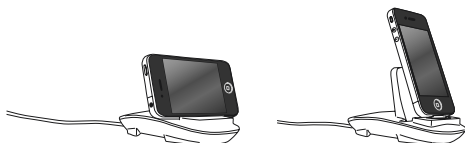

① Istruzioni per l'uso

Grazie per avere acquistato un prodotto Hama. Prima della messa in esercizio, leggere attentamente le presenti istruzioni per l'uso del prodotto.

Montaggio dello stand /della dockingstation

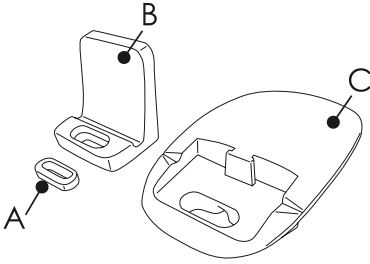

A : fissaggio per spina Apple 30 Pin in silicone
B : supporto per apparecchio
C : base

Assemblaggio dello stand / della docking Station

Passo 1:

Installare il componente B sulla base C.

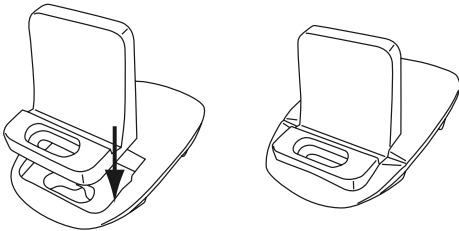

Passo 2:

Desiderate utilizzare il „Magic Stand“ come docking station? Procedere come segue:

Introdurre la spina originale Apple 30 Pin (00106351: non compresa nella fornitura) attraverso i componenti C + B.

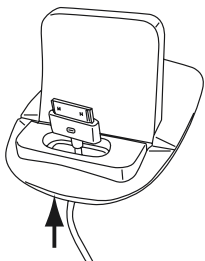

Passo 3:

Fissare la spina a 30 Pin mediante il fissaggio spina in silicone (A).

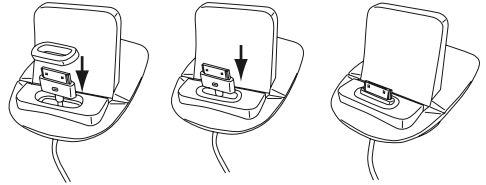

Passo 4:

Fissare il cavo sul lato inferiore nell'organizer cavi prevista.

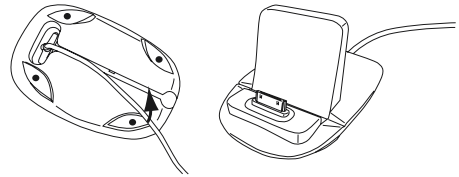

Il „Magic Stand“ è pronto per l'utilizzo con iPhone/iPod/iPad.

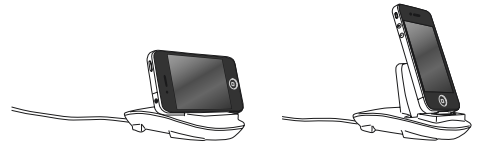

GR Οδηγίες χρήσης

Σας ευχαριστούμε που διαλέξατε προϊόν της Hama.
Πριν την έναρξη λειτουργίας του προϊόντος διαβάστε τις παρεχόμενες οδηγίες χρήσης.

Δομή του στηριγματος/της μονάδας σύνδεσης

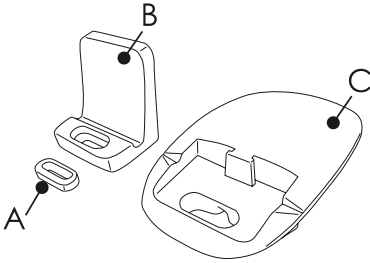

A: Στηρίγμα σιλκόνης Apple με υποδοχή 30 ακίδων
B: Στηρίγμα συσκευών
Γ. Βάση

Συναρμολόγηση του στηριγματος/της μονάδας σύνδεσης

Βήμα 1:

Εγκαταστήστε το εξάρτημα B στη βάση Γ.

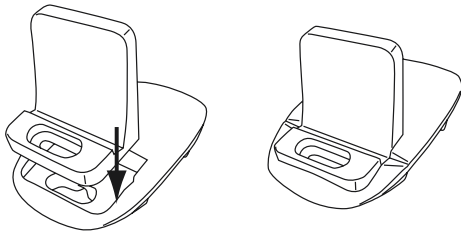

Βήμα 2:

Θέλετε να χρησιμοποιήσετε το „Magic Stand“ σαν μονάδα σύνδεσης; Για το σκοπό αυτό ενεργήστε ως εξής:

Περάστε το γνήσιο βύσμα 30 ακίδων Apple (00106351: δεν περιλαμβάνεται στη συσκευασία) μέσα από τα εξαρτήματα Γ + Β.

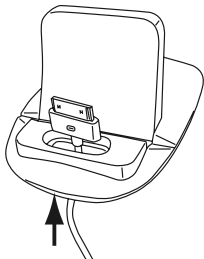

Βήμα 3:

Στερεώστε τώρα το βύσμα 30 ακίδων μέσω του στηριγματος με βύσμα σιλκόνης (A).

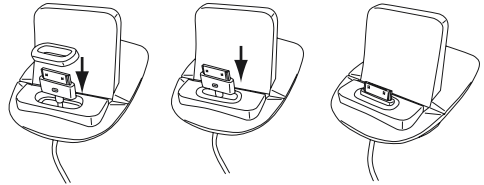

Βήμα 4:

Στερεώστε τώρα το καλώδιο στην κάτω πλευρά της προβλεπόμενης θήκης καλωδίων.

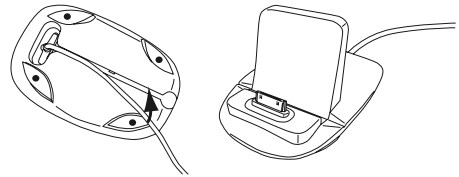

Το „Magic Stand“ είναι έτοιμο για χρήση με το iPhone/iPod/iPad

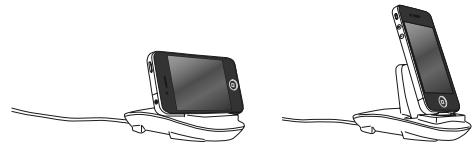

Ⓢ Bruksanvisning

Tack för att du valt en Hama-produkt. Läs den här bruksanvisningen innan du börjar använda produkten.

Stativets/dockningsstationen uppbyggnad

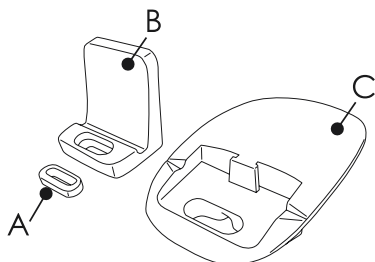

A : Silikon – Apple 30-pin hane fixering

B: Apparathållare

C : Bas

Sätta ihop stativet/dockningsstationen

Steg 1:

Installera komponenterna B på basen C.

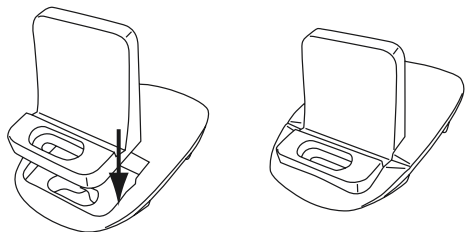

Steg 2:

Vill du använda "Magic Stand" som dockningsstation?
Då gör du så här:

Skjut original Apple 30-pin hanen
(00106351: medföljer inte) genom komponenterna C + B.

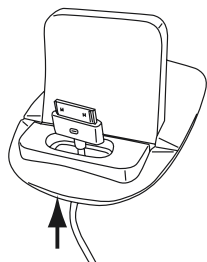

Steg 3:

Fixera nu 30-pin hanen med hjälp av silikon-hane-fixeringen (A).

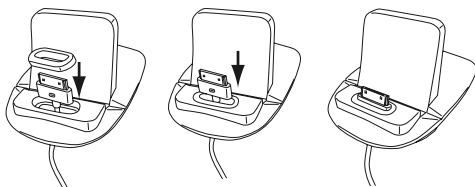

Steg 4:

Fäst nu kabeln på den undre sidan, i kabelhållaren som är till för detta.

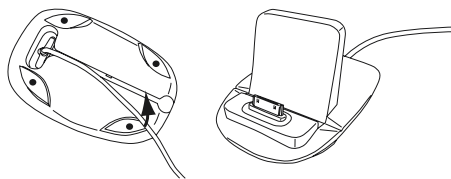

Nu är din "Magic Stand" klar för användning med
din iPhone/iPod/iPad

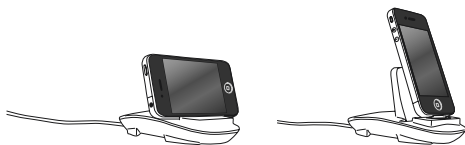

Kiitos, että valitsit Hama-tuotteen. Lue oheinen käyttöohje ennen tuotteen käyttöönottoa.

Telineen/telakointiaseman rakenne

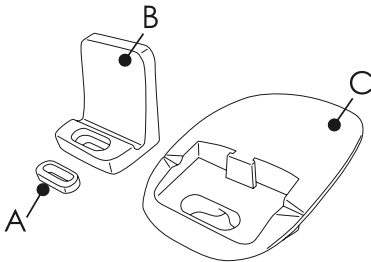

A : Silikoninen Applen 30-nastaisen liittimen kiinnitys

B : Laiteteline

C : Tukiasema

Telineen/telakointiaseman kokoaminen

Vaihe 1:

Asenna komponentti B tukiasemaan C.

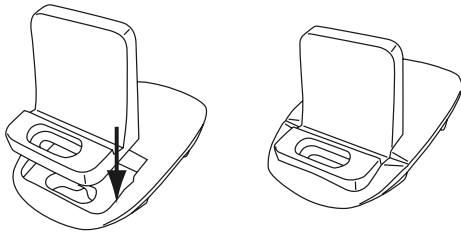

Vaihe 2:

Haluatko käyttää „Magic Stand:iä” telakointiasemana?
Menettele siinä tapauksessa seuraavalla tavalla:

Työnnä alkuperäinen Applen 30-nastainen liitin (00106351: ei sisälly toimitukseen) komponenttien C + B läpi.

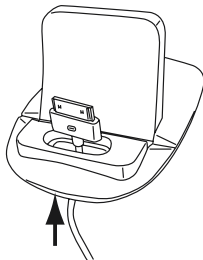

Vaihe 3:

Kiinnitä 30-nastainen liitin seuraavaksi silikonisella liittimen kiinnityksellä (A).

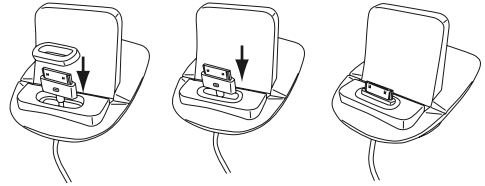

Vaihe 4:

Kiinnitä kaapeli sen jälkeen sen alapuolelta sille tarkoitettuun kaapelijärjestimeen.

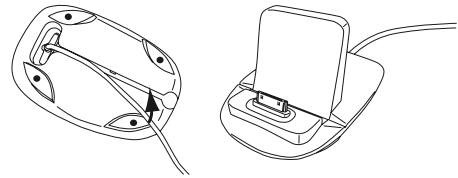

„Magic Stand” on nyt valmis käytettäväksi iPhone/iPodin/iPadin kanssa

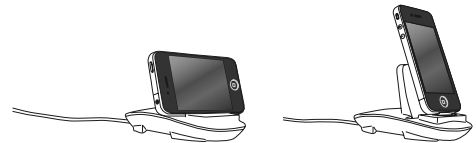

PL Operating Instruction

Dziękujemy za zakup produktu Hama. Przed pierwszym użyciem należy dokładnie zapoznać się z instrukcją obsługi.

Budowa podstawki stacji dokującej

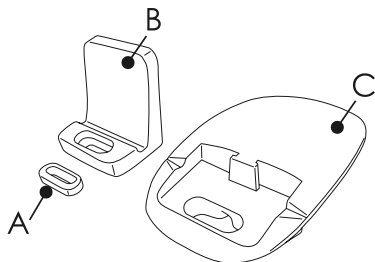

A: Silikonowa wkładka mocująca do wtyku Apple 30-pin
B: Uchwyt urządzenia
C: Stacja bazowa

Złożenie podstawki stacji dokującej

Krok 1:

Zamocować element B na stacji bazowej C.

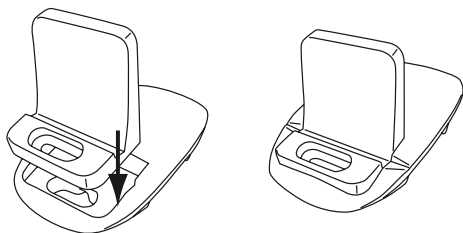

Krok 2:

Jeżeli stacja „Magic Stand” będzie wykorzystywana jako stacja dokująca, należy postąpić następująco:

Oryginalny wtyk Apple 30-pin (00106351: nie jest zawarty w zestawie) należy przeprowadzić przez elementy C+B.

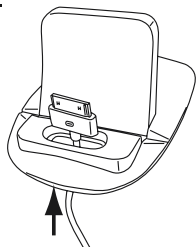

Krok 3:

Wtyk Apple 30-pin należy zamocować za pomocą wkładki silikonowej (A).

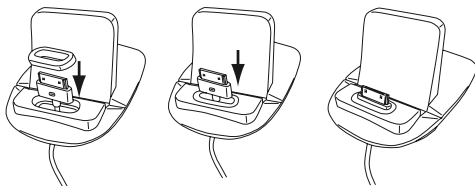

Krok 4:

Zamocować kabel na dole stacji bazowej za pomocą odpowiedniego organizera.

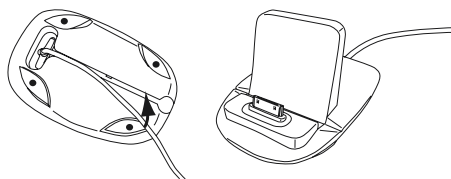

Stacja „Magic Stand” jest gotowa do użytku z iPhone/iPod/iPad.

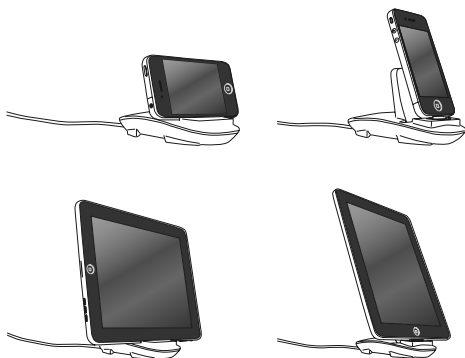

H Használati útmutató

Köszönjük, hogy ezt a Hama-terméket választotta!
Kérjük, figyelmesen olvassa el az útmutatót, mielőtt
használatba venné ezt az eszközt.

Az állvány/dokkoló állás felépítése

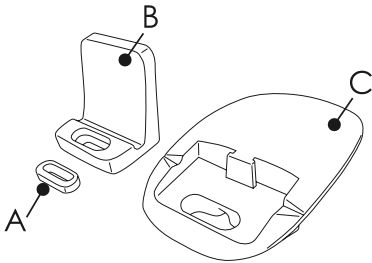

V: Szilikon - az Apple 30-tűs dugasz rögzítéséhez

B: Készülék-tartó

C: Alap

Az állvány/dokkoló állás összeszerelése

1. lépés:

Telepítse a B-komponens egységet a C alapra

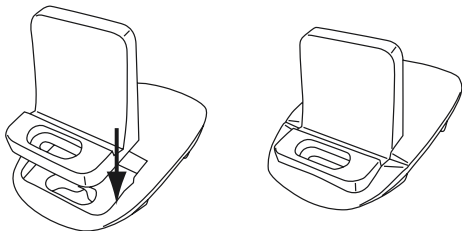

2. lépés:

Dokkoló állomásként akarja használni a „Magic Stand”-ot? – akkor végezze el a következő műveleteket:

Vezesse át az eredeti Apple 30-tűs dugaszt (00106351: nem tartozék) a C + B komponensre.

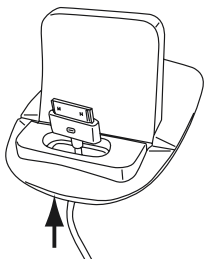

3. lépés:

Most rögzítse a 30-tűs dugaszt a helyén, a szilikon rögzítő dugóval (A).

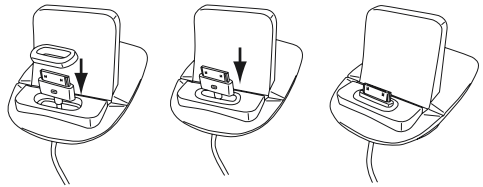

4. lépés:

Ezután erősítse fel a kábelt az alsó oldalon a megfelelő kábel-rendszerezővel.

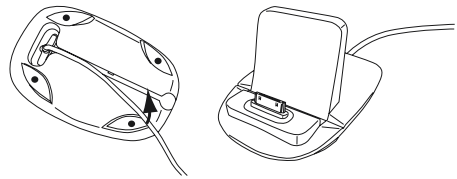

Most már használatra kész az Ön „Magic Stand”-ja az iPhone/iPod/iPad készülékhez

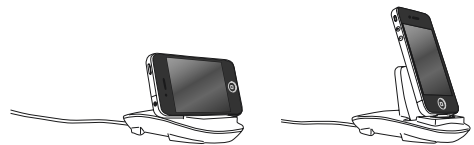

Ⓢ Návod k použití

Děkujeme Vám, že jste se rozhodli pro výrobek Hama. Před použitím si přečtěte tento návod.

Popis

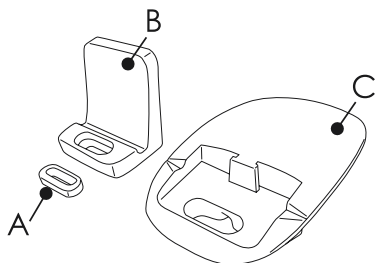

A: Silikonová fixace konektoru Apple 30-pin

B: Držák přístroje

C: Základna

Montážní stojan / dokovací stanice

Krok 1

Nainstalujte část B na základnu C.

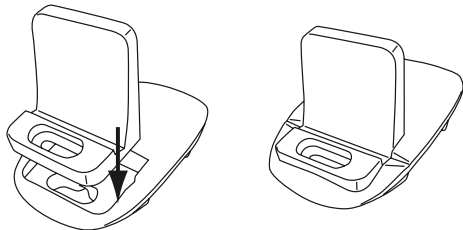

Krok 2

Chcete „Magic Stand“ použít jako Docking-Station?
Potom vedte originální konektor Apple 30-pin
(00106351: není součástí dodávky) přes díly C + B.

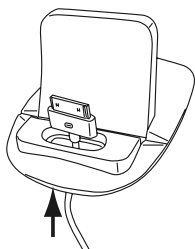

Krok 3

Konektor upevněte pomocí silikonové fixace.

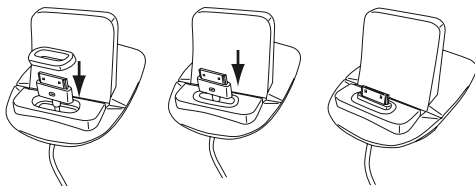

Krok 4

Kabel řádně upevněte na spodní straně.

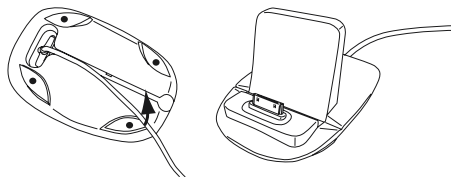

Vaše „Magic Stand“, je nyní připraven pro použití s
vaším iPhone / iPod / IPAD

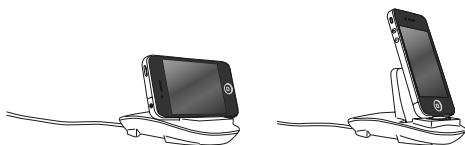

SK Návod na použitie

Ďakujeme, že ste sa rozhodli pre výrobok firmy Hama.
Pred uvedením výrobku do prevádzky si, prosím,
prečítajte príložený návod na obsluhu.

Konštrukcia stojana / dokovacej stanice

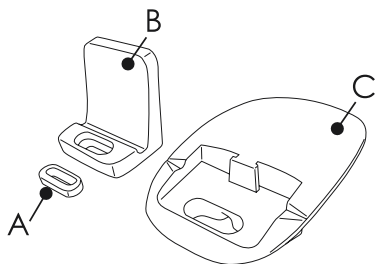

A : Silikónová fixácia 30-pinového Apple konektora
B : Prístrojový držiak
C : Základňa

Montáž stojana / dokovacej stanice

Krok 1:

Inštalujte komponent B na základňu C.

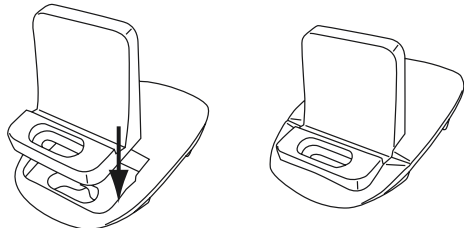

Krok 2:

Chcete použiť „Magic Stand“ ako dokovaciu stanicu?
Potom postupujte takto:

Prestrčte originálny 30-pinový Apple konektor
(00106351: nie je súčasťou dodávky) cez komponenty
C + B.

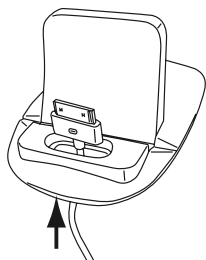

Krok 3:

30-pinový konektor teraz zafixujte pomocou silikónovej
fixácie pre konektory (A).

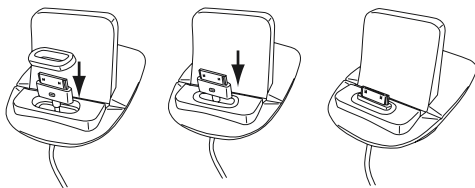

Krok 4:

Kábel teraz upevnite na spodnej strane v príslušnom
organizéri káblov.

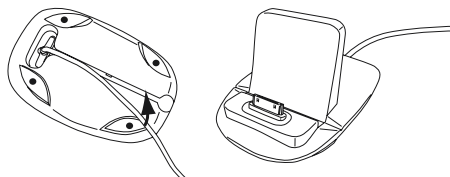

Váš stojan „Magic Stand“ je teraz pripravený na
použitie s vašim iPhonom/iPodom/iPadom

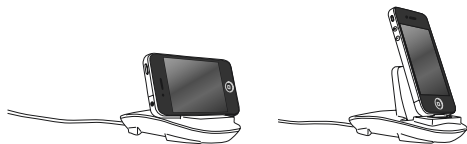

Ⓟ Manual de instruções

Agradecemos que se tenha decidido por este produto Hama. Leia estas instruções de uso antes de colocar o produto em funcionamento.

Estrutura do suporte/estação de ancoragem

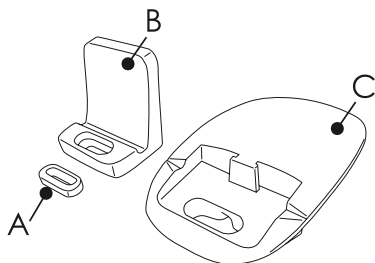

A : Fixação em silicone da ficha de 30 pinos da Apple

B : Suporte para aparelho

C : Base

Montagem do suporte/estação de ancoragem

Passo 1:

Instale o componente B na base C.

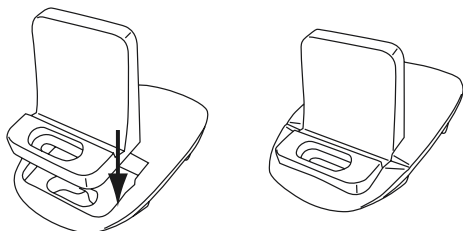

Passo 2:

Quer usar o „Magic Stand” como estação de ancoragem?
Então proceda do seguinte modo:

Passa a ficha de 30 pinos original da Apple
(00106351: não incluída no kit fornecido) através dos
componentes C + B.

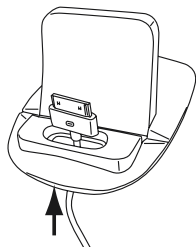

Passo 3:

Fixe, agora, a ficha de 30 pinos com o auxílio da
fixação em silicone (A).

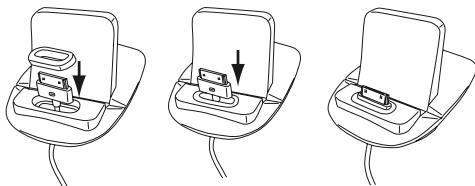

Passo 4:

Fixe, agora, o cabo no lado inferior do organizador
de cabos previsto.

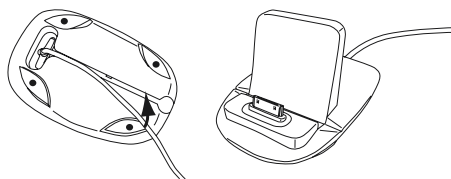

O seu „Magic Stand” está agora pronto a ser
utilizado com o seu iPhone/iPod/iPad

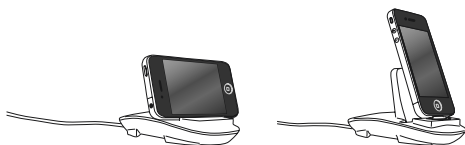

(RUS) Руководство по эксплуатации

Благодарим за покупку изделия фирмы Nana. Перед началом эксплуатации внимательно ознакомьтесь с настоящей инструкцией.

Конструкция стыковочного узла

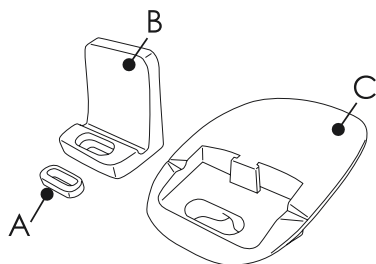

A : силиконовый фиксатор 30-конт. штекера Apple

B : держатель

C : основной блок

Сборка стыковочного узла

- 1)**
Установите узел B на основной блок C

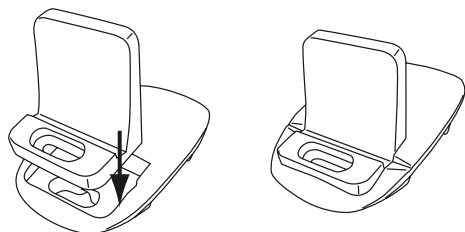

- 2)**
Чтобы „Magic Stand” применить в качестве стыковочного узла, выполните следующее:

Вставьте 30-конт. штекер Apple (00106351 : в комплект не входит) в узлы C и B.

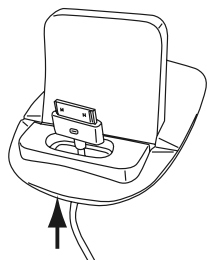

- 3)**
Закрепите 30-конт. штекер с помощью силиконового фиксатора (A).

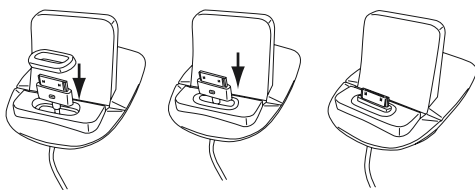

- 4)**
Вставьте кабель в предназначенный для него паз на нижней панели.

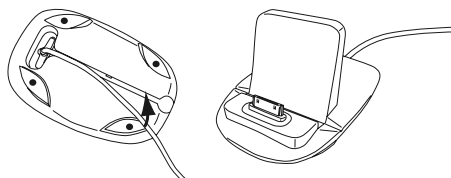

Теперь «Magic Stand» готов к работе с iPhone/iPod/iPad.

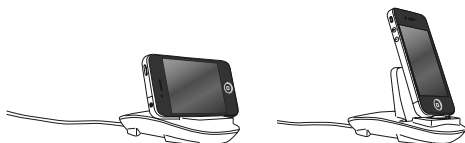

TR Kullanma kılavuzu

Bir Hama ürünü satın aldığınız için teşekkür ederiz. Ürünü devreye almadan önce, lütfen bu işletme kılavuzunu dikkatlice okuyunuz.

Ayağın / kenetleme istasyonunun yapısı

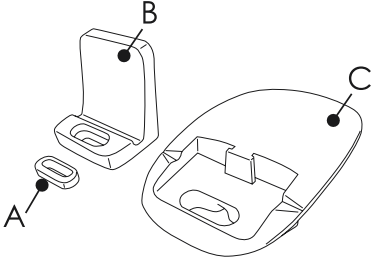

A : Silikon – Apple 30-Pin-fiş tespit
B : Cihaz tutucu
C : Baz

Ayağın / kenetleme istasyonunun montajı

Adım 1:

B bileşenini C bazına takın.

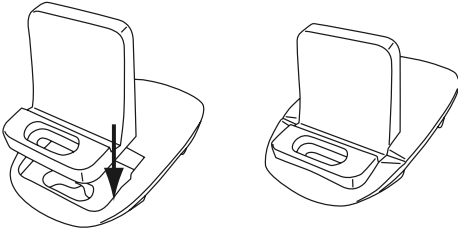

Adım 2:

„Magic Stand“ kenetleme istasyonu olarak kullanılacak mı? Bu durumda yapılacak olanlar:

Orijinal Apple 30-Pin-fişi (00106351: teslimat içeriğine dahil değildir) C + B parçalarından geçirin.

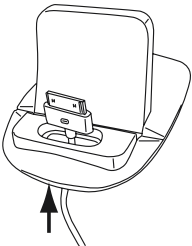

Adım 3:

Şimdi de 30-Pin fişi silikon fiş tespit elemanı (A) yardımı ile tespit edin.

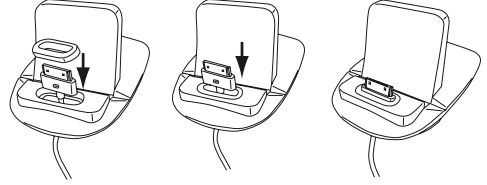

Adım 4:

Şimdi de kabloyu alt tarafta öngörülen kablo düzenleyiciye tespit edin.

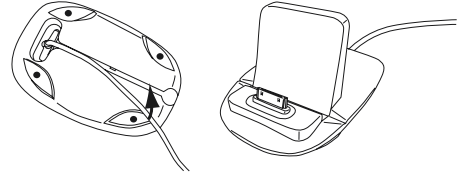

„Magic Stand“ iPhone/iPod/iPad ile kullanılabilir artık.

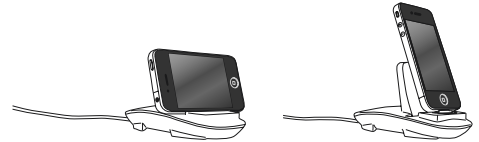

RO Manual de utilizare

Vă mulțumim că ați optat pentru un produs Hama.
Înainte de punerea în funcțiune citiți cu atenție manualul de utilizare livrat. .

Montarea standului / a docking station

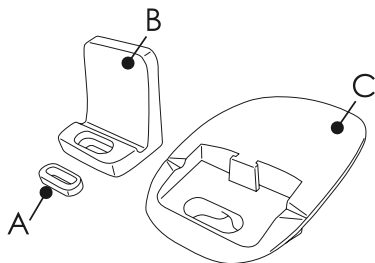

A : Silicon – Mufă Apple 30 pini - fixe

B: Suport aparate

C : Baza

Montarea standului / a docking station

Pasul 1:

Instalați componenta B pe baza C.

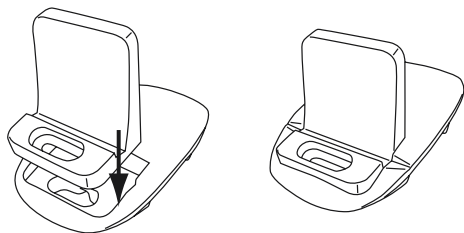

Pasul 2:

Doriți să folosiți „Magic Stand“-ul drept docking station?
Pentru aceasta procedați în felul următor:

Introduceți mufa originală Apple cu 30 pini (00106351: nu este în setul livrat) prin componentele C + B.

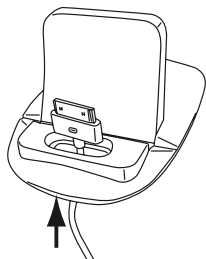

Pasul 3:

Fixați mufa cu 30 pini cu ajutorul mufei de fixare din silicon (A).

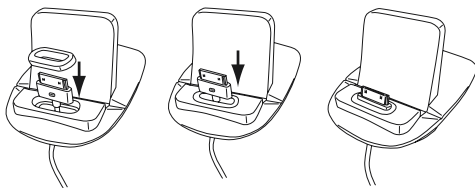

Pasul 4:

Acum fixați cablul pe latura de jos în locașul prevăzut.

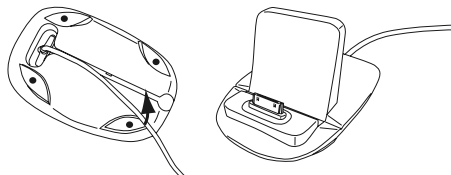

„Magic Stand“-ul dumneavoastră este gata pentru utilizarea cu iPhone/iPod/iPad-ul.

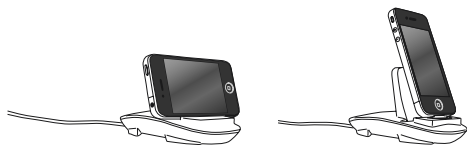

hama[®]

Hama GmbH & Co KG
D-86651 Monheim/Germany
www.hama.com

All listed brands are trademarks of the corresponding companies. Errors and omissions excepted, and subject to technical changes. Our general terms of delivery and payment are applied.

00106351_00106379/06.11