

00054828
(DR10)

hama®

THE SMART SOLUTION

Digital Radio

Digital-Radio

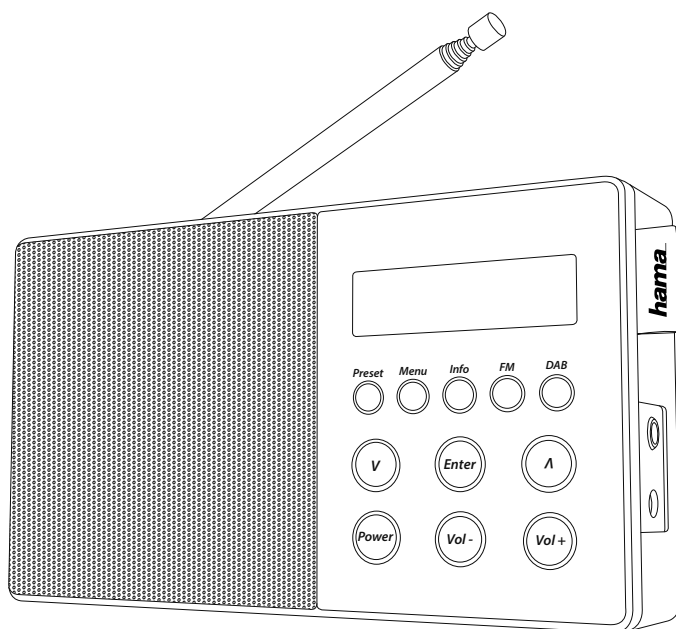

Operating Instructions / Bedienungsanleitung / Mode d'emploi / Instrucciones de uso /
Руководство по эксплуатации / Istruzioni per l'uso / Gebruiksaanwijzing / Οδηγίες χρήσης / Instrukcja obsługi /
Használati útmutató / Návod k použití / Návod na použitie / Manual de instruções / Kullanma kılavuzu /
Manual de utilizare / Bruksanvisning / Käyttöohje / Работна инструкция / Betjeningsvejledning / Manuelt stasjonssøk

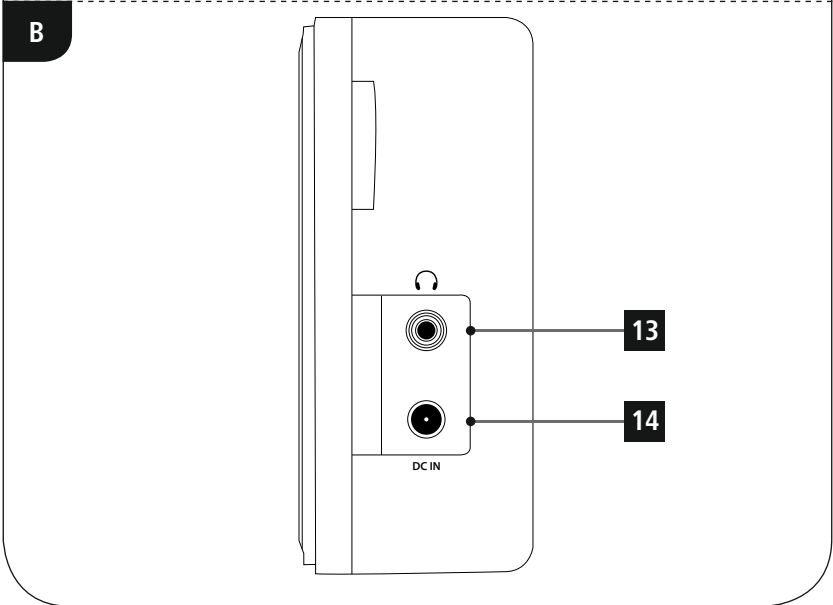
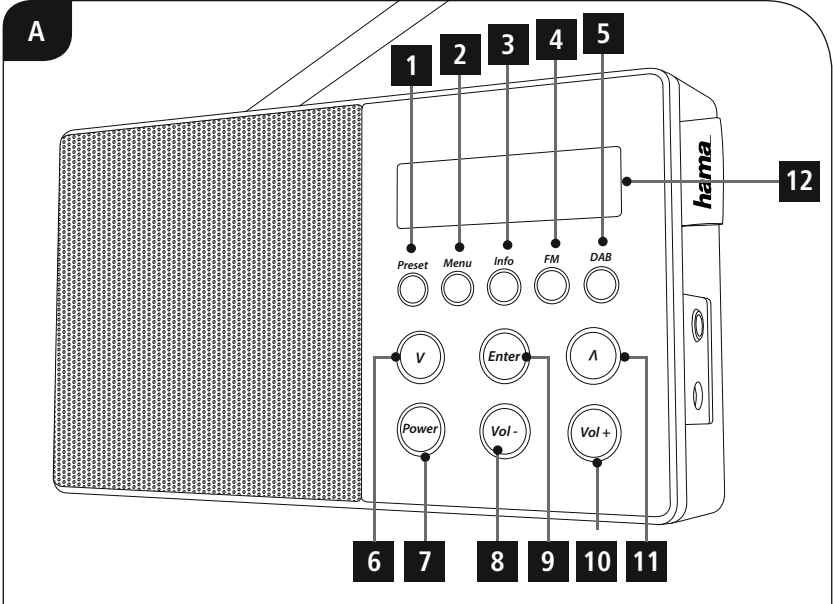

Technical Data / Technische Daten

Radio Receiver/ Radio Empfänger	DAB ✓	DAB+ ✓	FM ✓	Internet -	Spotify -
Display/ Bildschirm	2.1" Liquid Crystal Display (LCD)				
Speaker/ Lautsprecher	0.5 W RMS				
Power input/ Stromeingang	DC 6 V \equiv 500 mA, 4x AA Battery (not included)				
Frequency range/ Frequenzbereich	DAB/DAB+: 174 ~ 240 MHz		FM: 87.5 ~ 108 MHz		
Sensitivity/ Empfindlichkeit	DAB/DAB+: -97 ~ -99 dBm		FM: -105 ~ -109 dBm		
Power Consumption/ Stromaufnahme	Operation/ Betrieb	max. 3 W	Standby/ Bereitschaft	~ 0.5 W	
Input & Output/ Anschlüsse	DC Socket, 3.5 mm Earphone Jack				
Presets/ Favoriten	DAB/DAB+: 30	FM: 30			
Codec/ Formate	DAB: MP2, AAC				
UI Languages/ UI Sprachen	English, French, German, Italian, Finnish, Dutch, Danish, Norwegian, Polish, Swedish, Slovak, Czech				
Package Content/ Verpackungsinhalt	Quick Guide, AC/DC Adapter Kurzanleitung, Netzteil				
Dimension (WxD)/ Größe (BxHxT)	163 x 95 x 39				
Weight/ Gewicht	340 g				

Controls and Displays

A: Front		
1	[Preset]	List / save favourites
2	[Menu]	Direct access to the menu
3	[Info]	Display additional information
4	[FM]	Changing to operation mode FM
5	[DAB]	Changing to operation mode DAB
6	[▼]	Navigation key down
7	[Power]	On / off switch
8	[Vol-]	Decrease volume
9	[Enter]	Confirm
10	[Vol+]	Increase volume
11	[▲]	Navigation key up
12		2,1" 2x16 LCD

B: Side		
13		Headphone socket
14		Mains power supply

C: Rear		
15		Battery compartment

1. Explanation of Warning Symbols and Notes	4
2. Package Contents	4
3. Safety notes	4
4. Information and notes before getting started	5
5. Getting started	5
5.1 Battery operation	5
5.2 Mains operation	5
5.3 General notes on use	5
5.4 Initial setup	6
5.5 Language	6
6. DAB	6
6.1 Search / Automatic search	7
6.2 Manual station search	7
6.3 Station list	8
6.4 Edit station list	8
6.5 Favourites	8
6.5.1 Save favourites	8
6.5.2 Access favourites	8
6.6 DRC (Dynamic Range Control)	9
7. FM	9
7.1 Scan setting	9
7.2 Automatic station search	10
7.3 Manual station search	10
7.4 Favourites	10
7.4.1 Save favourites	10
7.4.2 Access favourites	10
7.5 Audio setting	10
8. Additional settings	11
8.1 Factory Reset	11
8.2 Info / Software version	11
9. Care and Maintenance	11
10. Warranty Disclaimer	11
11. Service and Support	11
12. Recycling Information	
Note on environmental protection:	11

Menu structure

DAB

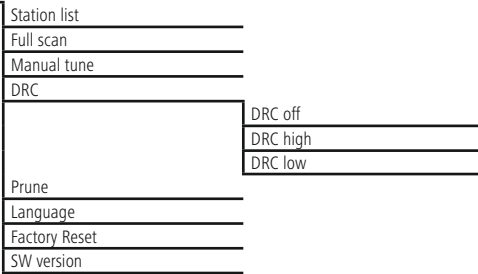

FM

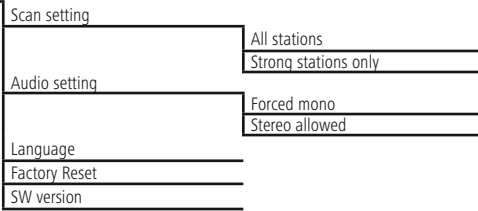

Thank you for choosing a Hama product.

Take your time and read the following instructions and information completely. Please keep these instructions in a safe place for future reference. If you sell the device, please pass these operating instructions on to the new owner.

1. Explanation of Warning Symbols and Notes



Risk of electric shock

This symbol indicates product parts energized with a dangerous voltage of sufficient magnitude to constitute a risk of electric shock.



Warning

This symbol is used to indicate safety instructions or to draw your attention to specific hazards and risks.



Note

This symbol is used to indicate additional information or important notes.

2. Package Contents

- Digital radio DR10
- Power supply unit
- Quick guide

3. Safety notes

- The product is intended for private, non-commercial use only.
- Protect the product from dirt, moisture and overheating and use it in dry rooms only.
- As with all electrical devices, this device should be kept out of the reach of children.
- Do not drop the product and do not expose it to any major shocks.
- Do not operate the product outside the power limits given in the specifications.
- Keep the packaging material out of the reach of children due to the risk of suffocation.
- Dispose of packaging material immediately according to locally applicable regulations.
- Do not modify the device in any way. Doing so voids the warranty.



Risk of electric shock

- Do not open the device or continue to operate it if it becomes damaged.
- Do not use the product if den AC adapter, adapter cable or power cable is damaged.
- Do not attempt to service or repair the product yourself. Leave any and all service work to qualified experts.



Warning - Batteries

- When inserting batteries, note the correct polarity (+ and - markings) and insert the batteries accordingly. Failure to do so could result in the batteries leaking or exploding.
- Do not allow children to change batteries without supervision.
- Remove the batteries from products that are not being used for an extended period.
- Do not short-circuit batteries.
- Do not charge batteries.
- Do not throw batteries in a fire.
- Keep batteries out of the reach of children.
- Do not mix old and new batteries or batteries of a different type or make.



4. Information and notes before getting started

Note – Optimal reception

Please note:

- Extend the antenna always completely.
- For best reception it's recommended to extend the antenna vertical.
- Try various different positions if necessary to get the best reception.

5. Getting started

5.1 Battery operation

- Open the battery compartment cover. It is located on the rear of the radio.
- Slide the battery compartment cover in the direction indicated.
- Insert the batteries paying attention to the match the polarities correctly. The correct polarity is indicated by the plus and minus symbols in the battery compartment.
- Replace the battery compartment cover.

5.2 Mains operation

Connect the network cable to a properly installed and easily accessible network socket.

The power supply unit is suitable for mains voltages between 100 and 240 V, and is thus operable on almost any AC power grid. Please note that a country-specific adapter may be necessary.

You can find an appropriate selection of Hama products at www.hama.com.

Note

- Only connect the product to a socket that has been approved for the device.
- The electrical socket must always be easily accessible.
- When using a multi-socket power strip, make sure that the sum power draw of all the connected devices does not exceed its maximum throughput rating.
- If you will not be using the product for a long period of time, disconnect it from mains power.

5.3 General notes on use

Notes on use

- When a selection among menu items is to be made (such as **Y** or **N**), the one currently selected flashes.
- In menus offering a variety of different options (such as DRC, language and so on), the currently selected option is marked with *.

Navigation and controls

- Select among menu items by pressing the **navigation keys [▲]/[▼]**.

Confirm the selection by pressing **[Enter]**.

This procedure is indicated in these operating instructions by the following symbols:

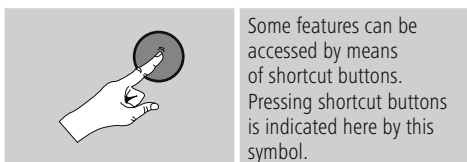
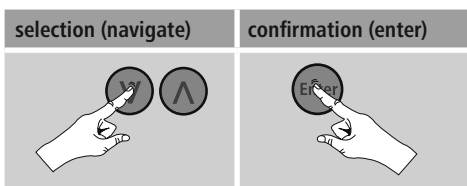

After pressing a shortcut button, navigate amongst the menu items using the **navigation keys [▲]/[▼]** and **[Enter]**.

Volume adjustment

You can turn the volume up/ down by pressing **[Vol+]/[Vol-]**.



Additional Information

Press **[Info]** to display context-dependent additional information. The information shown depends on the operating mode as well as the current selection of radio station.

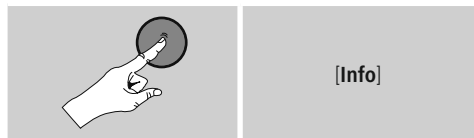

• Description

Indicates the radio station, the current program, contents, subjects, etc.

• Program genre/ country

Indicates the genre (music style) and the country or region of the station.

• Bit-Rate

The currently received digital bit rate of the received station is displayed.

• Codec

Specifies the encoding scheme used to digitise the data or signal (such as MP3 or WMA).

• Sampling rate

Specifies the sampling rate, or the frequency with which the audio signal is polled (Sampling-/Samplerate), in a certain period of time.

• Signal strength

The signal strength of the received station is displayed via a bar and its length.

• Today's date

• Time

• Signal error

• Service is not available

It's displayed when there is currently no DAB reception.

Switching on/off

Press **[Power]** to switch the radio on or off.

5.4 Initial setup

The **station search** in the operating mode DAB starts up automatically when the radio is turned on for the first time. By default, the radio starts with the English menu navigation. Set up your desired language as described in **5.5. Language**.

5.5 Language

To change the menu language from that selected at first-time startup, proceed as follows:

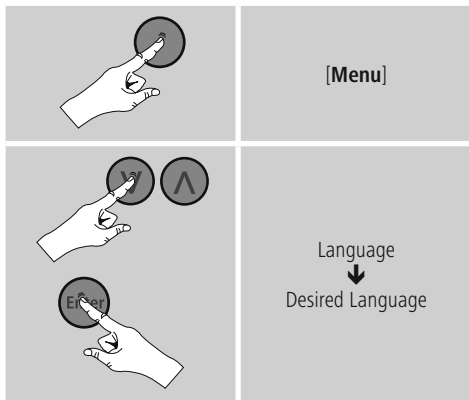

6. DAB

The radio receives all established digital radio frequencies in the range of 174 MHz (band III, channel 5A to 13F).

- Press **[DAB]** to activate the operating mode **DAB**:

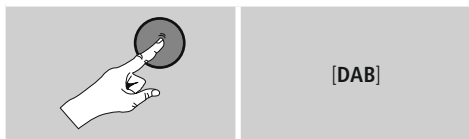

6.1 Search / Automatic search

The automatic DAB channel search scans the DAB band III for available stations. After the station search, all interference-free stations are saved in alphabetical order. The automatic DAB station search starts automatically when DAB mode is started for the first time; it is indicated by **Scanning...** and a status bar on the display. If you would like to start the search again, proceed as follows:

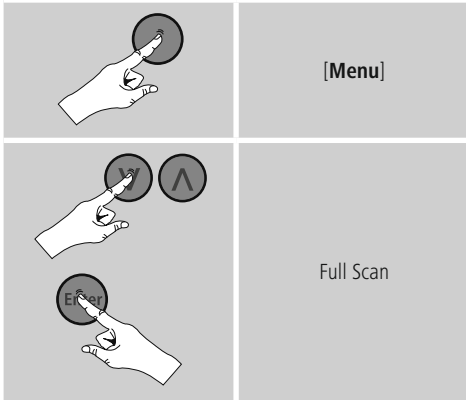

6.2 Manual station search

With the manual station search function you can search through individual frequencies and channels. If you know the frequency of the desired station and the automatic station search failed to find it, use this feature to set the reception frequency directly.

Proceed as follows, choosing a frequency range between 5A and 13F:

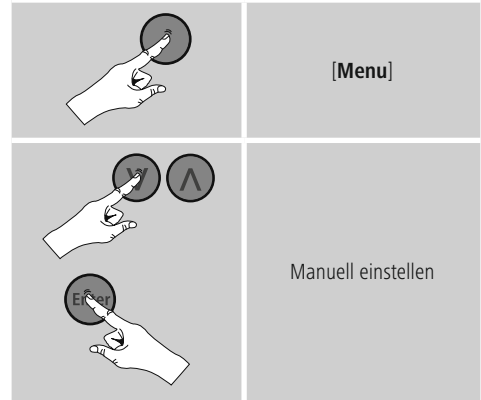

The bar indicates the current signal strength. The marking along the bar indicates the value required for interference-free reception. If this value is not reached (the bar is empty), then the signal strength is not sufficient on this channel.



6.3 Station list

You can access the station list in DAB mode at any time via two methods:

a) If a station is already playing, simply press the **navigation keys [▲]/[▼]**. The radio will then display the station list.

b)

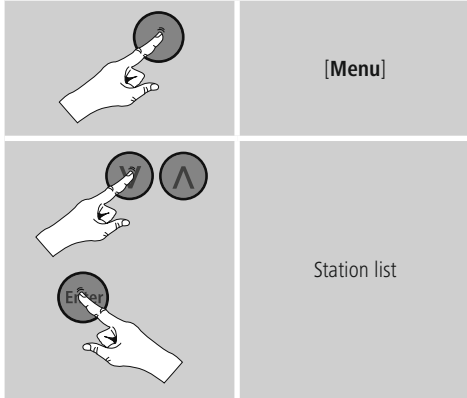

6.4 Edit station list

To remove stations that are not currently in the reception area, from your station list, proceed as follows:

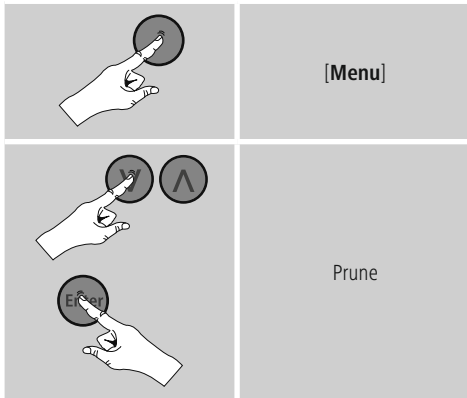

If you answer **Yes**, then all currently unavailable stations will be removed from the station list.

6.5 Favourites

You can save up to 30 of your favourite stations for quick and direct access.

6.5.1 Save favourites

- Set the station that you would like to save as a favourite station preset.
- If the station is received, press and hold **[Preset]** on the front of the radio.

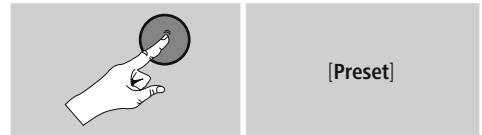

- An overview window with the station presets should open after approx. 2 seconds.
- You can switch between the station presets (1 to 30) by pressing the **navigation keys [▲]/[▼]**.
- Press **[Enter]** to save the station on the desired station preset.

6.5.2 Access favourites

Press **[Preset]** to open the overview window with the list of saved stations.

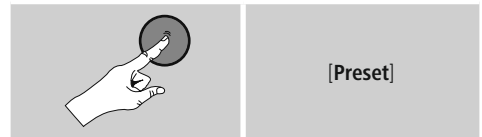

Use the **navigation keys [▲]/[▼]** and **[Enter]** to select one of your favourites.

Note

- Favourites cannot be deleted.
- If all 30 station memory slots are filled and you wish to save a new station, choose one of the occupied slots. The station in this slot will be overwritten with the new station.

6.6 DRC (Dynamic Range Control)

Some radio stations in the DAB network support an audio level control that is activated at varying volumes during playback. If the audio level suddenly rises during playback, DRC automatically reduces the volume. The same happens if playback suddenly becomes quieter, with the radio then increasing the volume.

This radio has three different settings for DRC:

DRC high:

total equalisation of different volumes. Strong compression can audibly reduce the dynamics of a music title.

DRC low:

partial equalisation of different volumes. More subtle compression, without too much loss of dynamics.

DRC off:

no equalisation.

Proceed as follows to do the settings:

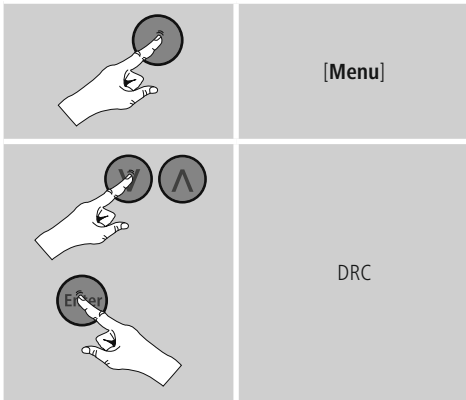

7. FM

Press **[FM]** to activate the operating mode **FM**:

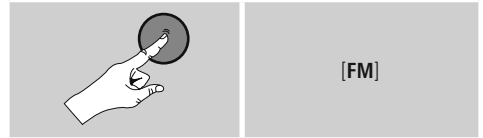

7.1 Scan setting

The search run setting allows you to determine whether stations with low signal strength are ignored during the automatic search run.

Proceed as follows:

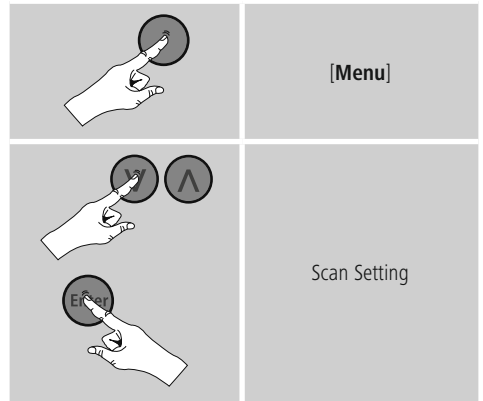

To have the search run stop only at stations with high signal strength, select **Strong stations only**. Otherwise (**All stations**), the search run will stop at every station for which a signal is received.



7.2 Automatic station search

- Press and hold one of the **navigation keys** [**▲**]/[**▼**] until the automatic station search starts.
- The radio stops the search and starts playback when it finds a station.
- Press again one of the **navigation keys** [**▲**]/[**▼**] to continue the search until the next station is found.

7.3 Manual station search

When you make station settings manually, you can define the desired frequency yourself and tune into stations that were ignored during automatic station search because their signals were too weak.

- Press the **navigation keys** [**▲**]/[**▼**] ([**▲**]:+ 0.05 MHz / [**▼**]:- 0.05 MHz) until you see the desired frequency. Wait a moment until playback of the received station signal begins.

7.4 Favourites

You can save up to 30 of your favourite stations for quick and direct access.

7.4.1 Save favourites

- Set the station that you would like to save as a favourite station preset.
- If the station is received, press and hold [**Preset**] on the front of the radio.

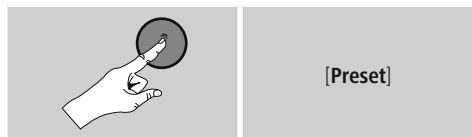

- An overview window with the station presets should open after approx. 2 seconds.
- You can switch between the station presets (1 to 30) by pressing the **navigation keys** [**▲**]/[**▼**].
- Press [**Enter**] to save the station on the desired station preset.

7.4.2 Access favourites

Press [**Preset**] to open the overview window with the list of saved stations.

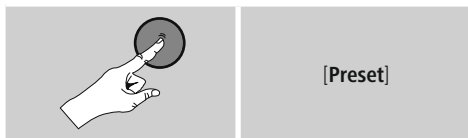

Use the **navigation keys** [**▲**]/[**▼**] and [**Enter**] to select one of your favourites.

Note

- Favourites cannot be deleted.
- If all 30 station memory slots are filled and you wish to save a new station, choose one of the occupied slots. The station in this slot will be overwritten with the new station.

7.5 Audio setting

For some stations with a weak signal, quality can be slightly improved by playing them in mono quality. You can enable this function in the menu (**Forced mono**), and the radio will automatically switch to mono reception when signal quality is poor.

To change the audio setting, proceed as follows:

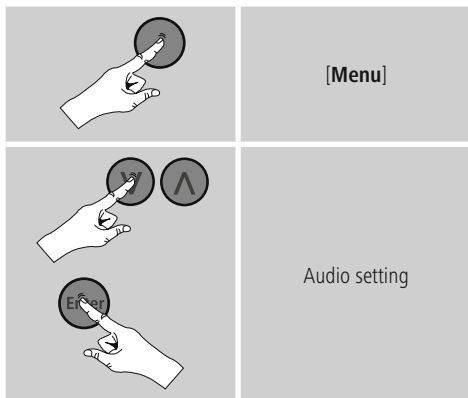

8. Additional settings

8.1 Factory Reset

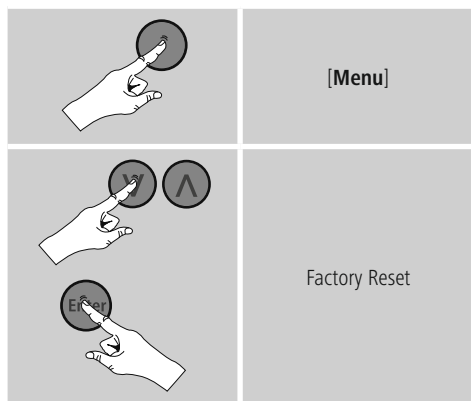

Confirm the following prompt with **Yes** to reset the radio to the factory default settings. All settings made previously are deleted.

 **Note**

- Resetting to the factory default settings can solve some problems and malfunctions.
- However, all settings made previously, such as favourites and station lists, are permanently deleted.

8.2 Info / Software version

To have the radio display information about its software, proceed as follows:

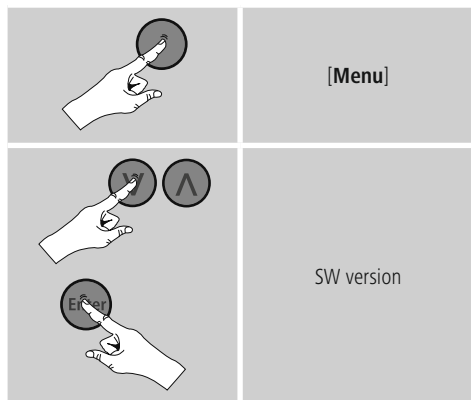

9. Care and Maintenance

- Only clean this product with a slightly damp, lint-free cloth and do not use aggressive cleaning agents.
- If you do not use the product for a long time, turn off the device and disconnect it from the power supply. Store it in a clean, dry place out of direct sunlight.

10. Warranty Disclaimer

Hama GmbH & Co KG assumes no liability and provides no warranty for damage resulting from improper installation/ mounting, improper use of the product or from failure to observe the operating instructions and / or safety notes.

11. Service and Support

Please contact Hama Product Consulting if you have any questions about this product.

Hotline: + 49 9091 502-115 (German/English)

Further support information can be found here:
www.hama.com

12. Recycling Information

Note on environmental protection:



After the implementation of the European Directive 2012/19/EU and 2006/66/EU in the national legal system, the following applies: Electric and electronic devices as well as batteries must not be disposed of with household waste. Consumers are obliged by law to return electrical and electronic devices as well as batteries at the end of their service lives to the public collecting points set up for this purpose or point of sale. Details to this are defined by the national law of the respective country. This symbol on the product, the instruction manual or the package indicates that a product is subject to these regulations. By recycling, reusing the materials or other forms of utilizing old devices/ batteries, you are making an important contribution to protecting our environment.

13. Declaration of Conformity

 Hereby, Hama GmbH & Co KG declares that the radio equipment type [00054828] is in compliance with Directive 2014/53/EU. The full text of the EU declaration of conformity is available at the following internet address:

www.hama.com -> 00054828 -> Downloads.



hama®

Hama GmbH & Co KG
86652 Monheim/Germany
www.hama.com

All listed brands are trademarks of the corresponding companies. Errors and omissions excepted, and subject to technical changes. Our general terms of delivery and payment are applied.

00054828/05.18